

LASER LEVEL

Manual in English

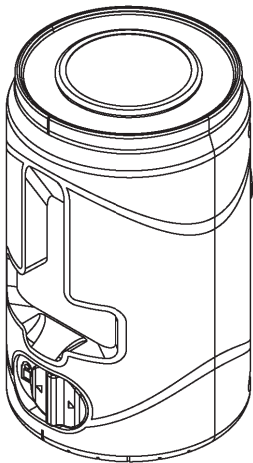

Version: T05/06 200528

Contents

Congratulations!

You have chosen one of our laser levels that's guaranteed reliable and tough for professional tool users at various job sites.

- SAFETY
- PRODUCT OVERVIEW
- SPECIFICATION
- OPERATING
- MAINTENANCE
- WARRANTY

SAFETY

- Read the Safety Instructions and Manual thoroughly before using this product. All users must fully understand and adhere to these instructions.
- While the product is in operation, be careful not to expose your eyes to the emitting laser beam (red light source). Exposure to a laser beam for an extended time may be hazardous to your eyes.
- Do not stare directly into the beam or view directly with optical instruments or set up the laser at eye level.
- Do not disassemble the laser tool. There are no user serviceable parts inside.

- Do not modify the laser in any way. Modifying the tool may result in hazardous Laser Radiation Exposure.
- Do not operate the laser around children or allow children to operate the laser.
- An exposure to the beam of a Class 2 laser is considered safe for a maximum of 0.25 seconds. Eyelid reflexes will normally provide adequate protection.

PRODUCT OVERVIEW

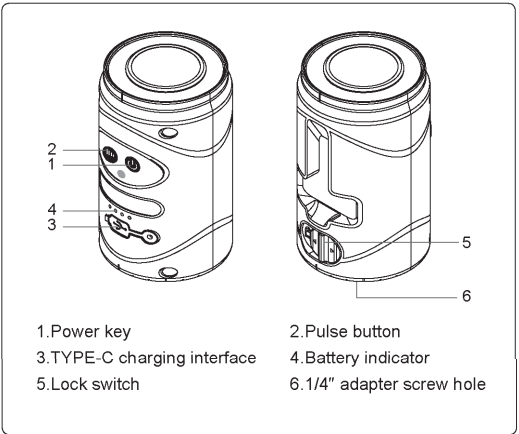

SPECIFICATION

Laser Class	Class II
Laser Wavelength	630~670nm for Red beam 505~550nm for Green beam
Leveling Accuracy	±1.5mm/5m
Leveling/Compensation Range	4°±1°
Working Distance (Line)	15m(100LUX) for Red beam 30m(100LUX) for Green beam
Operating Time	Red Beam : First gear: about 13 Hours Fourth gear: about 27 Hours Green beam: First gear: about 4 Hours Fourth gear: about 9 Hours
Power Source	3.7V 1000mAh lithium battery
IP Rating	IP54
Operation Temperature Range	-10℃~+50℃
Storage Temperature Range	-25℃~+70℃

OPERATING

keep the Lock Switch at '  ' position during moving the laser level or storage it.

  It is very important!

1.self-leveling mode

Turn Lock Switch at '  ' position, both of vertical beam and horizontal laser beam are lighting up, the device will be self-leveling.Indicator light is green.(If key indicator light is red and lines flashed, it indicates lines are not level, please put laser level on much flatter place, because the self-leveling rang is about 4°)

Short press the power button, the horizontal line closed and the vertical line works. Short press the power button again, the vertical line closed, and the horizontal line works. Press the power button again, the horizontal line and the vertical line are cyclical

Turn Lock Switch at '  ' position, laser level stop working.

2.Locked Mode:

When Lock Switch at '  ' position, long-press key button, both of vertical and horizontal laser beams light up and flash every 5 seconds , the Indicator light is red.

Short press the power button, the horizontal line closed, and the vertical line works, blinking every 5 seconds.

Short press the key again, the horizontal line works, and the vertical line closed, blinking every 5 seconds.

Short press the key again, both of the horizontal line and vertical line are working, blinking every 5 seconds.

Cyclical

In this case, you can tilt the spirit level arbitrarily.

Press and hold the power button to turn off the laser level.

3. Energy saving mode:

In auto self-leveling mode and locked mode, short press the pulse key, the brightness of the light can be adjusted, the brightness is divided into 4 levels, and the key cycle.

4.pulse mode:

In auto self-leveling mode, long-press the '  ' button, the pulse mode is turning on, long-press again to switch off pulse mode .In this mode, energy saving mode is invalid.



The Indicator light is 4 green LED light, the quantity of indicator lights less show that the power less. It means power weak when there are only one LED light flashes, the device should be charged in time.

MAINTENANCE

- The laser tool is sealed and calibrated at the plant to the accuracy specified.

- It's recommended to carry out a accuracy check before its first use and periodic checks during future use especially for precise layouts.

- Do not store the laser tool in direct sunlight or expose it to high temperatures.

The housing and some internal parts are made of plastics and may become deformed at high temperatures.

- Exterior plastic parts may be cleaned with a damp cloth. Although these parts are solvent resistant, NEVER use solvents. Use a soft, dry cloth to remove moisture from the tool before storage.

- Do not dispose of this product with household waste.

WARRANTY

1. We provide one year warranty on the Laser Level from the date of purchase

2. The warranty card must be provided when the instrument is under warranty, and the invoice should be provided.

3. Please contact your local dealer for repair or replacement Disclaimer.

The following conditions without warranty

I Unauthorized disassemble of instruments

II Wrong operating or man-made damage to the instrument

III Did not use the original accessories and cause damage

IV Give the instrument to unauthorized person or unit for repair

V Product serial number was deleted